

PART NUMBER DESIGNATION						
PT	-	M3	-	10	-	CU
PT	-	S	-	M3	-	X
Type	Material Code	Thread Code	Length Code	Finish Code		

All dimensions are in millimeters.

METRIC	Thread Size x Pitch	Type		Thread Code	Length Code "L" ± 0.4										H1 ± 0.3	∠ +/-1°	D2 ± 0.2	H2 max.	C ± 0.08	A ± 0.05
		Fastener Material																		
		Carbon Steel	Stainless Steel																	
M3x0.5	PT	PTS	M3	6	8	10	12	14	16	18	20	25	-	1.0	3°	4.5	0.6	0.60	0.55	
M4x0.7	PT	PTS	M4	6	8	10	12	14	16	18	20	25	-	1.0		5.5	0.6	0.65		
M5x0.8	PT	PTS	M5	-	8	10	12	14	16	18	20	25	30	1.0		6.5	1.0	0.75	0.80	
M6x1.0	PT	PTS	M6	-	-	10	12	14	16	18	20	25	30	1.0		7.5				
M8x1.25	PT	PTS	M8	-	-	-	12	14	16	18	20	25	30	1.1		9.0	1.5	0.85		

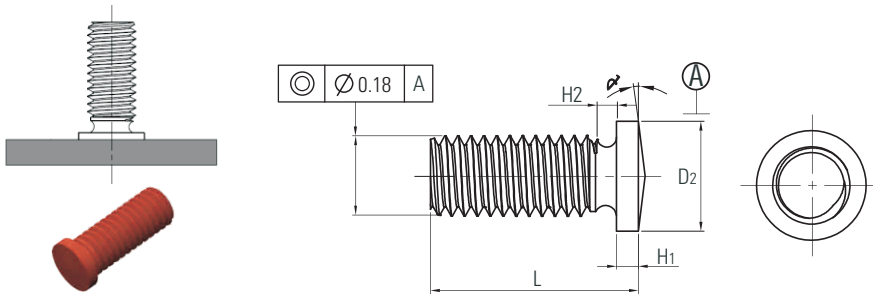

PART NUMBER DESIGNATION						
PS	-	M3	-	10	-	CU
PS	-	S	-	M3	-	X
Type	Material Code	Thread Code	Length Code	Finish Code		

All dimensions are in millimeters.

METRIC	Thread Size x Pitch	Type		Thread Code	Length Code "L" ± 0.4										H1 ± 0.3	∠ +/-1°	D2 ± 0.2	H2 max.
		Fastener Material																
		Carbon Steel	Stainless Steel															
M3x0.5	PS	PSS	M3	6	8	10	12	14	16	18	20	-	-	-	1.0	7°	4.0	0.6
M4x0.7	PS	PSS	M4	6	8	10	12	14	16	18	20	25	-	-	1.0		5.0	
M5x0.8	PS	PSS	M5	-	-	10	12	14	16	18	20	25	30	-	1.0		6.0	1.0
M6x1.0	PS	PSS	M6	-	-	10	12	14	16	18	20	25	30	-	1.0		7.0	
M8 x1.25	PS	PSS	M8	-	-	-	12	14	16	18	20	25	30	35	1.1		9.0	1.5
M10 x1.5	PS	PSS	M10	-	-	-	-	-	16	18	20	25	30	35	1.1		11.0	2.0