

PART NUMBER DESIGNATION

FK	-	M3	-	12	-	ZU
FK	-	S	-	M3	-	12
Type	Material Code	Thread Code	Length Code	Finish Code		

All dimensions are in millimeters.

METRIC	Thread Size x Pitch	Type			Thread Code	E +/-0.2	C +0.0/-0.08	Hole Size In Sheet +0.08/-0.0	Min. Sheet Thickness	Length "L" +0.05/-0.13																	
		Steel	Stainless Steel	Aluminum						3	4	5	6	-	-	-	-	-	-	-	-	-	-	-			
	M2x0.4	FK	FKS	FKA	M2	5.2	4.18	4.2	1.0	3	4	5	6	-	-	-	-	-	-	-	-	-	-	-	-	-	-
	M2.5x0.45	FK	FKS	FKA	M2.5	5.2	4.18	4.2	1.0	3	4	5	6	7	8	-	-	-	-	-	-	-	-	-	-	-	-
	M2.6x0.6	FK	FKS	FKA	M2.6	5.2	4.18	4.2	1.0	-	4	5	6	7	8	-	-	-	-	-	-	-	-	-	-	-	-
	M3x0.5	FK	FKS	FKA	M3	5.2	4.18	4.2	1.0	-	-	5	6	7	8	9	10	-	-	-	-	-	-	-	-	-	-
		FK	FKS	FKA	3.5M3	7.2	6.18	6.2	1.0	-	-	-	6	7	8	9	10	12	14	16	-	-	-	-	-	-	-
	M4x0.7	FK	FKS	FKA	M4	8.2	7.18	7.2	1.0	-	-	-	-	7	8	9	10	12	14	16	-	-	-	-	-	-	-
	M5x0.8	FK	FKS	FKA	M5	8.2	7.18	7.2	1.0	-	-	-	-	-	8	9	10	12	14	-	-	-	-	-	-	-	-

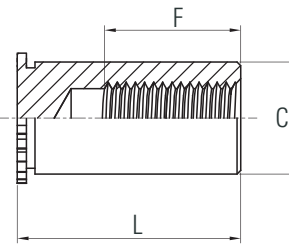
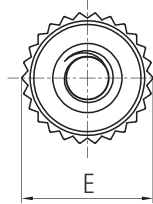
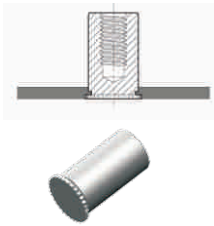

PART NUMBER DESIGNATION

FKB	-	M3	-	12	-	ZU
FKB	-	S	-	M3	-	12
FKB	-	A	-	M3	-	12
Type	Material Code	Thread Code	Length Code	Finish Code		

All dimensions are in millimeters.

METRIC	Thread Size x Pitch	Type			Thread Code	E +/-0.2	C +0.0/-0.08	Hole Size In Sheet +0.08/-0.0	Min. Sheet Thickness	Length "L" +0.05/-0.13																	
		Steel	Stainless Steel	Aluminum						6	7	8	-	-	-	-	-	-	-	-	-	-	-	-			
	M2x0.4	FKB	FKBS	FKBA	M2	5.20	4.18	4.20	1.0	6	7	8	-	-	-	-	-	-	-	-	-	-	-	-	-	-	-
	M2.5x0.5	FKB	FKBS	FKBA	M2.5	5.20	4.18	4.20	1.0	6	7	8	9	10	-	-	-	-	-	-	-	-	-	-	-	-	-
	M2.6x0.6	FKB	FKBS	FKBA	M2.6	5.20	4.18	4.20	1.0	6	7	8	9	10	-	-	-	-	-	-	-	-	-	-	-	-	-
	M3x0.5	FKB	FKBS	FKBA	M3	5.20	4.18	4.20	1.0	6	7	8	9	10	11	12	14	-	-	-	-	-	-	-	-	-	-
		FKB	FKBS	FKBA	3.5M3	7.20	6.18	6.20	1.0	6	7	8	9	10	11	12	14	-	-	-	-	-	-	-	-	-	-
	M4x0.7	FKB	FKBS	FKBA	M4	8.20	7.18	7.20	1.0	6	7	8	9	10	11	12	14	16	18	20	-	-	-	-	-	-	-
	M5x0.8	DFKB	DFKBS	DFKBA	M5	8.20	7.18	7.20	1.0	6	7	8	9	10	11	12	14	16	18	20	-	-	-	-	-	-	-
Effective Thread Depth F Min.										3	4	5	6	8	10												