

PART NUMBER DESIGNATION			
ZK	- M4	- 1.5	- ZU
ZKS	- M4	- 1.5	- X
↓	↓	↓	↓
Type and Material	Thread Code	Shank Code	Finish Code

All dimensions are in millimeters.

METRIC	Thread Code	Type		Thread Code	Shank Code	A +0.15/ -0.05	Sheet Thickness	Hole Size In Sheet +0.08/-0	C +0/-0.13	E +/-0.15	T +/-0.13
		Carbon Steel	Stainless Steel								
	M3x0.5	ZK	ZKS	M3	1.0	1.0	1.0	5.0	4.98	7.00	3.0
					1.2	1.2	1.2				
					1.5	1.5	1.5				
					2.0	2.0	2.0				
	M4x0.7	ZK	ZKS	M4	1.2	1.2	1.2	6.0	5.98	8.00	4.0
					1.5	1.5	1.5				
					2.0	2.0	2.0				
	M5x0.8	ZK	ZKS	M5	1.5	1.5	1.5	8.0	7.98	10.00	5.0
					2.0	2.0	2.0				
					2.5	2.5	2.5				
	M6x1.0	ZK	ZKS	M6	1.5	1.5	1.5	9.0	8.98	11.00	6.0
					2.0	2.0	2.0				
					2.5	2.5	2.5				
	M8x1.25	ZK	ZKS	M8	2.0	2.0	2.0	11.0	10.98	13.00	6.0
					2.5	2.5	2.5				

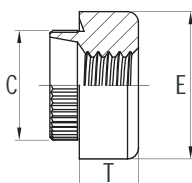
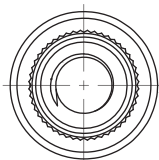
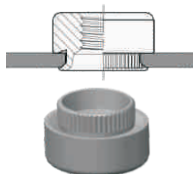

PART NUMBER DESIGNATION				
DARB	- M4	- 008	- S	- Z
↓	↓	↓	↓	↓
Type	Thread Code	Shank Code	Material Code	Finish Code

All dimensions are in millimeters.

DARB is compliance with Anchor Rivet® Bush specification

METRIC	Thread Code	Carbon Steel	Stainless Steel	Hole Size In Sheet +0.08/-0	C +0/-0.13	E +/-0.15	T +/-0.13
	M3x0.5	DARB-M3-XX-SZ	DARB-M3-XX-SS	5.85	5.80	7.90	3.20
	M3.5x0.6	DARB-M3.5-XX-SZ	DARB-M3.5-XX-SS	6.95	6.90	9.50	3.80
	M4x0.7	DARB-M4-XX-SZ	DARB-M4-XX-SS	6.95	6.90	9.50	3.80
	M5x0.8	DARB-M5-XX-SZ	DARB-M5-XX-SS	8.35	8.30	11.10	4.40
	M6x1.0	DARB-M6-XX-SZ	DARB-M6-XX-SS	9.65	9.50	12.70	5.70
	M8x1.25	DARB-M8-XX-SZ	DARB-M8-XX-SS	13.10	13.00	15.90	6.40
	M10x1.5	DARB-M10-XX-SZ	DARB-M10-XX-SS	15.50	15.40	19.10	7.60
	M12x1.75	DARB-M12-XX-SZ	DARB-M12-XX-SS	19.50	19.40	25.40	10.20

Shank Code	001	003	004	006	008	010	012
Sheet Thickness	0.5-0.6	0.7-0.8	0.9-1.0	1.1-1.3	1.4-1.6	1.7-1.9	2.0-2.2
Shank Code	013	014	016	018	019	020	022
Sheet Thickness	2.3-2.5	2.6-2.8	2.9-3.1	3.2-3.4	3.5-3.7	3.8-4.0	4.1-4.3